

Movimenti per ante
Wing movements
Compases para muebles

Series 0510 Con freno - With brake - Con freno

Acciaio
Steel
Acero



Acciaio zincocromato
Zinc chromium-plated
Acero zincocromado

Cod.

0510 mm 150	AT000510AZC15
510 mm 200	AT000510AZC20
511 mm 250	AT000511AZC25

Acciaio ottonato
Brass-plated steel
Acero latonado

Cod.

AT000510AOT15
AT000510AOT20
AT000511AOT25

Acciaio bronzato
Bronze-plated steel
Acero bronceado

Cod.

AT000510ABR15	50
AT000510ABR20	50
AT000511ABR25	50



- Per aumentare il freno, allentare la vite.
Loosen the screw, in order to increase the brake.
Para aumentar el freno, aflojar el tornillo.

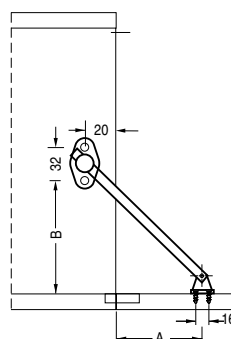

	A mm	B mm
Art. 0510	70	85
Art. 510	100	130
Art. 511	130	165

Series 524 Senza freno - Without brake - Sin freno

Acciaio
Steel
Acero



Acciaio zincocromato
Zinc chromium-plated
Acero zincocromado

Cod.

524 mm 150	AT000524AZC15
525 mm 200	AT000525AZC20
526 mm 250	AT000526AZC25

Acciaio ottonato
Brass-plated steel
Acero latonado

Cod.

AT000524AOT15
AT000525AOT20
AT000526AOT25

Acciaio bronzato
Bronze-plated steel
Acero bronceado

Cod.

AT000524ABR15	50
AT000525ABR20	50
AT000526ABR25	50

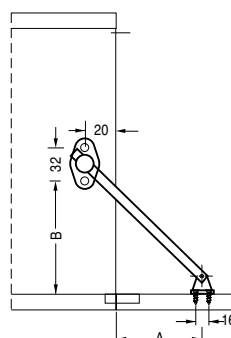

	A mm	B mm
Art. 524	70	85
Art. 525	100	130
Art. 526	130	165